

TOWNSHIP 15 NORTH, RANGE 19 EAST, OF THE INDIAN MERIDIAN, OKLAHOMA
DEPENDENT RESURVEY AND SURVEY

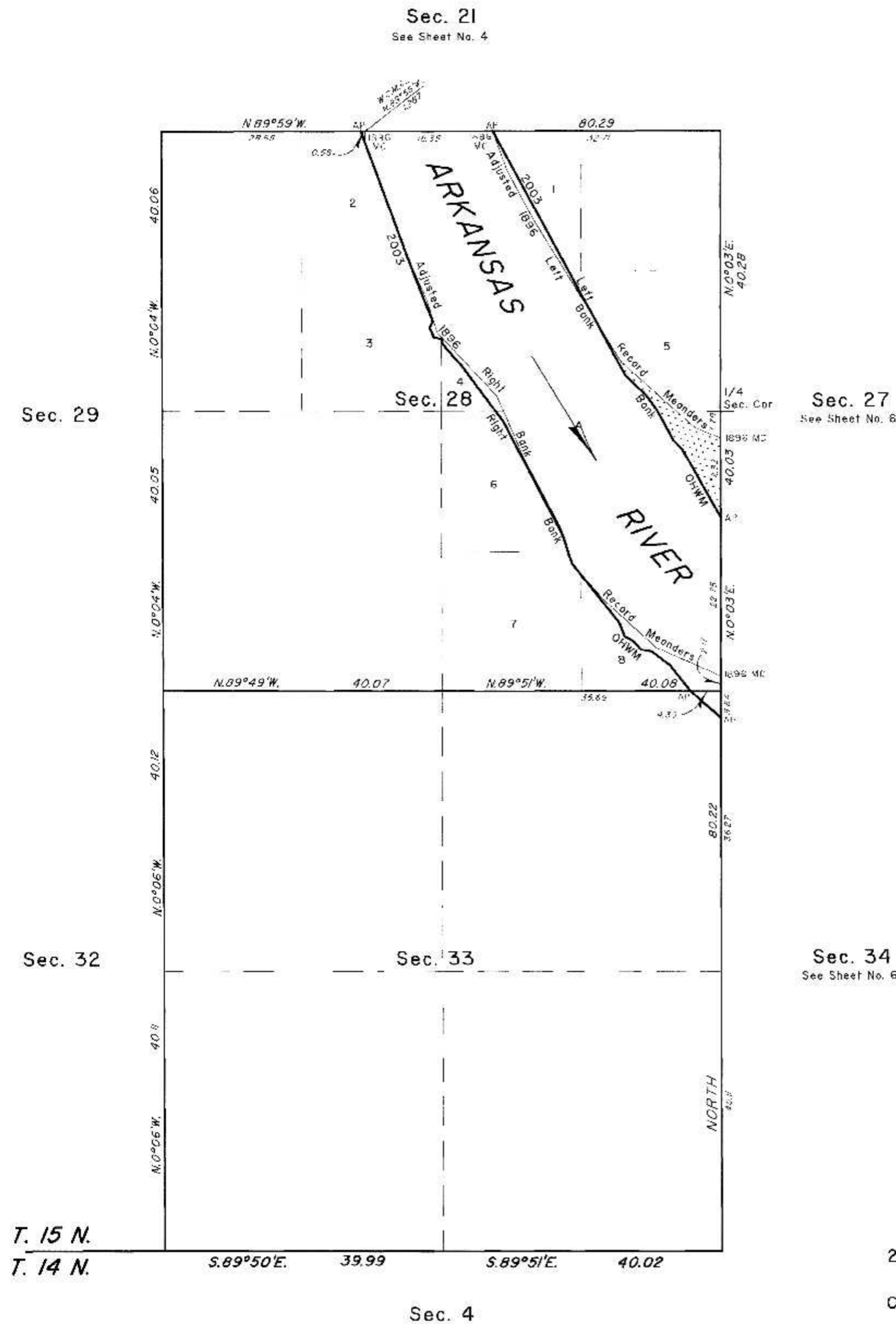

2003 Arkansas River in Section 28
Left Bank OHWM as Digitized

From AP, sections 27 and 28, at 2003 Left Bank OHWM, thence upstream in section 28;

N.29°32'W.,	11.78
N.46°01'W.,	1.66
N.29°02'W.,	5.09
N.34°41'W.,	2.39
N.45°58'W.,	4.27
N.28°26'W.,	9.55
Adj. 1896 L. B. Meanders	
N.28°28'W.,	30.51

AP sections 21 and 28

2003 Arkansas River in Sections 28 and 33
Right Bank OHWM as Digitized

From AP, sections 33 and 34, at 2003 Right Bank OHWM, thence upstream in section 33;

N.48°43'W.,	5.84
N.38°21'W.,	4.63
N.52°24'W.,	3.26
N.78°52'W.,	1.66
N.40°23'W.,	1.66
N.63°59'W.,	1.40
N.20°46'W.,	2.06
N.38°29'W.,	10.98
N.17°38'W.,	4.11
N.27°36'W.,	18.41
N.36°30'W.,	9.62
N.40°41'W.,	4.69
N. 0°05'E.,	0.57
N.75°29'W.,	1.21
N.23°43'W.,	1.58
N.26°20'E.,	1.00
N.2°46'W.,	8.27
N.20°14'W.,	20.84

AP sections 21 and 28

Adjusted 1896 Left Bank Record Meanders

From the 1896 MC, sections 27 and 28 thence;

N.67°28'W.,	4.01
N.48°17'W.,	14.05
N.3°36'W.,	7.684
2003 Left Bank OHWM	
N.3°36'W.,	16.436
N.28°22'W.,	8.04
N.19°54'W.,	5.93

1896 MC Secs. 21 and 28

Adjusted 1896 Right Bank Record Meanders

From the 1896 MC, sections 27 and 28 thence;

N.66°16'W.,	9.48
Historic Bank	
N.66°16'W.,	0.61
N.47°42'W.,	10.11
N.4°16'W.,	7.08
N.16°49'W.,	5.06
N.27°56'W.,	11.13
N.23°29'W.,	9.13
Historic Bank	
N.23°29'W.,	0.99
N.43°00'W.,	0.30
Historic Bank	
N.43°00'W.,	12.34
N.17°19'W.,	5.06
N.24°14'W.,	0.56
Historic Bank	
N.24°14'W.,	3.30
Historic Bank	
N.24°14'W.,	4.23
N.19°17'W.,	3.07
Historic Bank	
N.19°17'W.,	8.06
N.20°02'W.,	2.73
Historic Bank	
N.20°02'W.,	2.33
N.1°38'W.,	0.30
Historic Bank	
N.1°38'W.,	0.99

1896 MC Secs. 21 and 28

Reference should be made to sheet No. 1 for survey and disclaimer information.

UNITED STATES DEPARTMENT OF THE INTERIOR
BUREAU OF LAND MANAGEMENT

Sante Fe, New Mexico December 19, 2012

This plat is strictly conformable to the approved field notes, and the survey, having been correctly executed in accordance with the requirements of law and the regulations of this Bureau, is hereby accepted.

For the Director

Chief Cadastral Surveyor for New Mexico

2003 Arkansas Riverbed in Section 28
Claim Area ± 163.42 Acres
1896 Arkansas Riverbed
Claim Area ± 6.68 Acres

2003 Arkansas Riverbed in Section 33
Claim Area ± 0.84 Acres

1896 Riverbed Claim Area

