

TOWNSHIP 13 NORTH, RANGE 20 EAST, OF THE INDIAN MERIDIAN, OKLAHOMA

DEPENDENT RESURVEY AND SURVEY

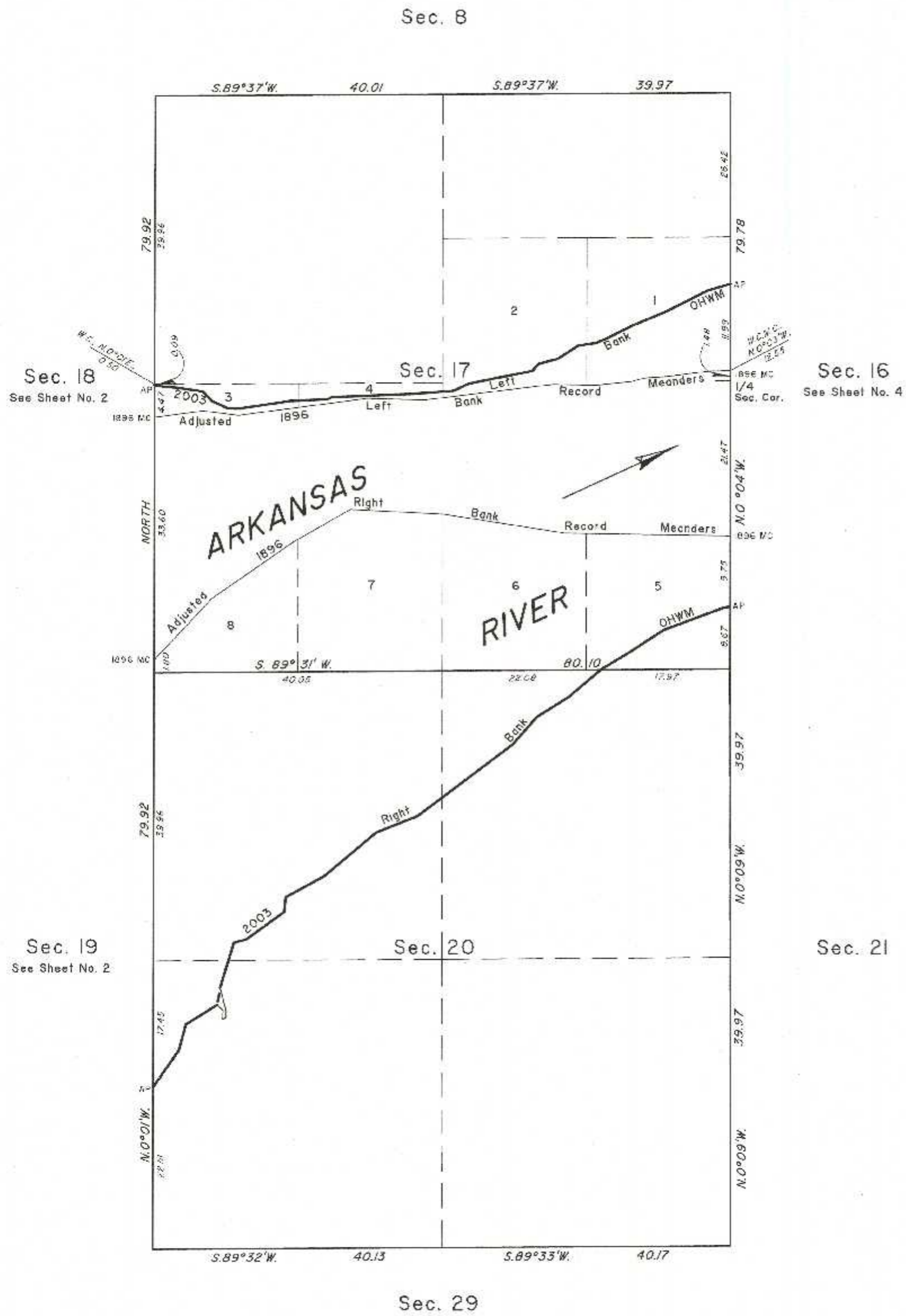

2003 Arkansas River in Section 17
Left Bank OHWM as Digitized

From AP, sections 16 and 17, at 2003 Left Bank OHWM, thence upstream in section 17;

S.72°46'W..	3.32
S.63°38'W..	6.56
S.67°02'W..	4.98
S.63°30'W..	4.14
S.67°59'W..	1.45
S.81°00'W..	2.55
S.57°32'W..	3.31
S.74°29'W..	2.73
S.43°19'W..	1.33
S.78°58'W..	5.75
S.77°53'W..	3.22
S.64°51'W..	2.37
S.95°46'W..	5.87
S.87°41'W..	11.02
S.65°06'W..	0.76
S.87°24'W..	5.14
S.81°26'W..	7.16
N.89°00'W..	1.65
N.64°44'W..	2.41
N.42°38'W..	1.75
N.8°52'W..	3.05
N.84°05'W..	3.46
N.73°28'W..	0.31

AP sections 17 and 18

2003 Arkansas River in Sections 17 and 20
Right Bank OHWM as Digitized

From AP, sections 16 and 17, at 2003 Right Bank OHWM, thence upstream in section 17;

S.77°30'W..	1.03
S.69°40'W..	8.81
S.56°33'W..	5.73
S.53°22'W..	4.30
S.49°34'W..	0.29
AP sections 17 and 20	
S.49°34'W..	5.82
S.58°02'W..	5.25
S.41°34'W..	5.10
S.52°55'W..	16.44
S.68°15'W..	6.19
S.50°03'W..	9.57
S.61°24'W..	6.01
S.6°03'W..	2.04
S.53°55'W..	6.44
S.73°13'W..	1.86
S.16°44'W..	6.53
S.9°31'W..	2.38
S.58°09'W..	5.10
S.15°09'W..	3.67
S.34°58'W..	6.28

AP sections 19 and 20

Adjusted 1896 Right Bank Record Meanders

From the 1896 MC, sections 17 and 18 thence;	
N.42°24'E..	11.07
N.55°19'E..	14.10
N.60°17'E..	9.07
S.87°12'E..	7.87
Historic Bank	
S.87°12'E..	5.21
S.81°29'E..	17.10
S.89°26'E..	13.76
Historic Bank	
S.89°26'E..	9.38
1896 MC Secs. 16 and 17	

Adjusted 1896 Left Bank Record Meanders

From the 1896 MC, sections 17 and 18 thence;	
N.84°34'E..	6.98
S.83°24'E..	4.98
N.82°16'E..	17.94
S.88°55'E..	7.97
N.82°48'E..	17.94
S.89°10'E..	3.05
Historic Bank	
S.89°10'E..	2.93
N.84°04'E..	4.88
N.74°17'E..	1.99
N.86°19'E..	2.99
N.82°48'E..	5.98
N.87°04'E..	2.91
1896 MC Secs. 16 and 17	

Reference should be made to sheet No. 1 for survey and disclaimer information.

UNITED STATES DEPARTMENT OF THE INTERIOR
BUREAU OF LAND MANAGEMENT

Sante Fe, New Mexico December 14, 2011

This plat is strictly conformable to the approved field notes, and the survey, having been correctly executed in accordance with the requirements of law and the regulations of this Bureau, is hereby accepted.

For the Director

Chief Cadastral Surveyor for New Mexico

2003 Arkansas Riverbed in Section 17
Claim Area ±324.77 Acres

2003 Arkansas Riverbed in Section 20
Claim Area ±152.56 Acres

