

TOWNSHIP 10 NORTH, RANGE 26 EAST, OF THE INDIAN MERIDIAN, OKLAHOMA  
SUPPLEMENTAL PLAT

R. 26 E. R. 27 E.

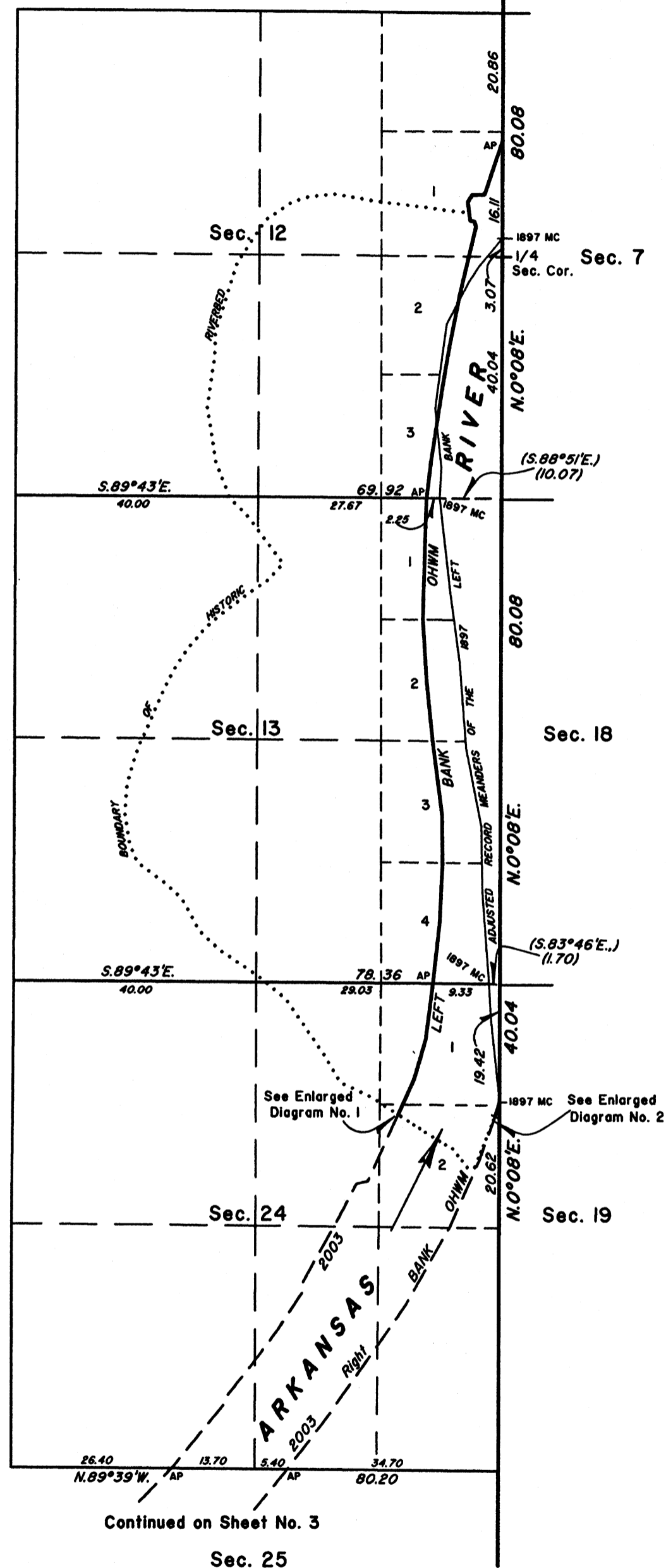

**2003 Arkansas Riverbed In Section 12**  
From AP, sections 7 and 12, at 2003 Left Bank OHWM, thence upstream in section 12:  
S.18°29'W., 9.41  
S.89°02'W., 2.06  
S.31°25'W., 1.36  
S. 7°44'E., 1.52  
S. 7°44'E., 1.59  
S.79°24'E., 0.70  
S.14°18'E., 0.92  
S.13°17'W., 11.53  
S.11°07'W., 8.58  
S. 9°32'W., 6.74  
S. 6°41'W., 12.63  
S. 6°44'W., 6.05  
AP, sections 12 and 13, S.89°43'E. 2.25  
1897 MC, sections 12 and 13, S.88°51'E. 10.07  
Cor. of S7-S12-S13-S18 N.0°08'E. 59.22  
AP, sections 7 and 12, at 2003 Left Bank OHWM, place of beginning, containing **± 43.87 Acres Claim Area**

**2003 Arkansas Riverbed In Section 13**  
From AP, sections 12 and 13, at 2003 Left Bank OHWM, thence upstream in section 13:  
S. 2°42'W., 3.21  
S. 1°33'W., 16.94  
S. 3°33'E., 10.27  
S. 5°49'E., 9.83  
S. 7°25'E., 12.16  
S. 0°42'E., 7.97  
S. 2°41'W., 9.77  
S. 6°18'W., 10.16  
AP, sections 13 and 24, S.89°43'E. 9.33  
1897 MC, sections 13 and 24, S.83°46'E. 1.70  
Cor. of S13-S18-S19-S24 N.0°08'E. 80.08  
Cor. of S7-S12-S13-S18 N.88°51'W. 10.07  
1897 MC, sections 12 and 13, N.89°43'W., 2.25  
AP, sections 12 and 13, at 2003 Left Bank OHWM, place of beginning, containing **± 89.93 Acres Claim Area**

**2003 Arkansas Riverbed In Section 24**  
From AP, sections 24 and 25, at 2003 Right Bank OHWM, thence downstream in section 24:  
N.37°29'E., 10.34  
N.34°58'E., 14.87  
N.34°17'E., 8.36  
N.29°30'E., 14.43  
N.23°53'E., 12.04  
N.20°07'E., 6.14  
N.17°54'E., 1.63  
Boundary of historic Riverbed S.21°41'W., 9.05  
N.89°53'W., 1.14  
N.38°45'W., 3.83  
N.59°27'W., 3.85  
N.57°07'W., 6.86  
2003 Left Bank OHWM, thence upstream:  
S.24°19'W., 0.04  
S.24°19'W., 12.02  
S.77°48'W., 1.94  
S.27°38'W., 7.92  
S.29°18'W., 11.04  
S. 4°09'E., 1.34  
S.33°21'W., 7.25  
S.36°02'W., 6.35  
S.37°55'W., 7.99  
S.16°47'W., 1.17  
S.39°14'W., 13.35  
AP, sections 24 and 25, S.89°39'E. 19.10  
AP, sections 24 and 25, at 2003 Right Bank OHWM, place of beginning, containing **± 100.19 Acres Non-Claim Area**

**2003 Arkansas Riverbed In Section 24**  
From AP, sections 13 and 24, at 2003 Left Bank OHWM, thence upstream in section 24:  
S. 7°20'W., 9.37  
S.16°07'W., 6.84  
S.24°19'W., 6.33  
Boundary of historic Riverbed S.57°07'E., 6.86  
S.59°27'E., 3.85  
S.38°45'E., 3.83  
S.89°53'E., 1.14  
N.21°41'E., 9.05  
2003 Right Bank OHWM, thence downstream:  
N.17°54'E., 2.36  
1897 MC, sections 19 and 24, N.0°08'E. 19.42  
Cor. of S13-S18-S19-S24 N.83°46'W. 1.70  
1897 MC, sections 13 and 24, N.89°43'W. 9.33  
AP, sections 13 and 24, at 2003 Left Bank OHWM, place of beginning, containing **± 35.03 Acres Claim Area**

ENLARGED DIAGRAM No. 1

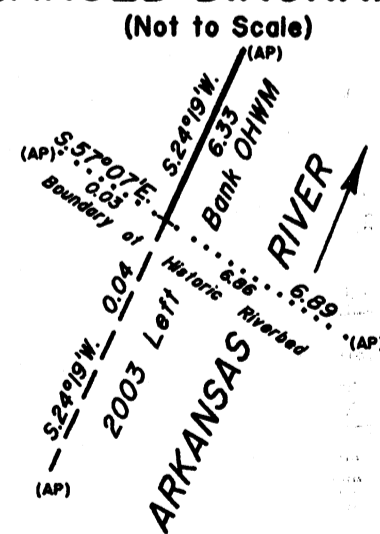

ENLARGED DIAGRAM No. 2

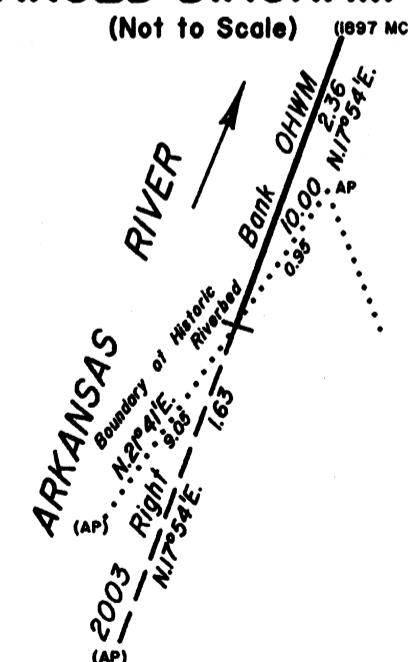

Reference should be made to sheet No. 1 for survey information.

UNITED STATES DEPARTMENT OF THE INTERIOR  
BUREAU OF LAND MANAGEMENT

Santa Fe, New Mexico October 2, 2008

This plat, showing amended boundaries and areas is based upon the official records and, having been correctly prepared in accordance with the regulations of this Bureau is hereby accepted.

For the Director

*Wm. A. Cassard*

Chief Cadastral Surveyor for New Mexico

