

TOWNSHIP 10 NORTH, RANGE 25 EAST, OF THE INDIAN MERIDIAN, OKLAHOMA
DEPENDENT RESURVEY AND SURVEY

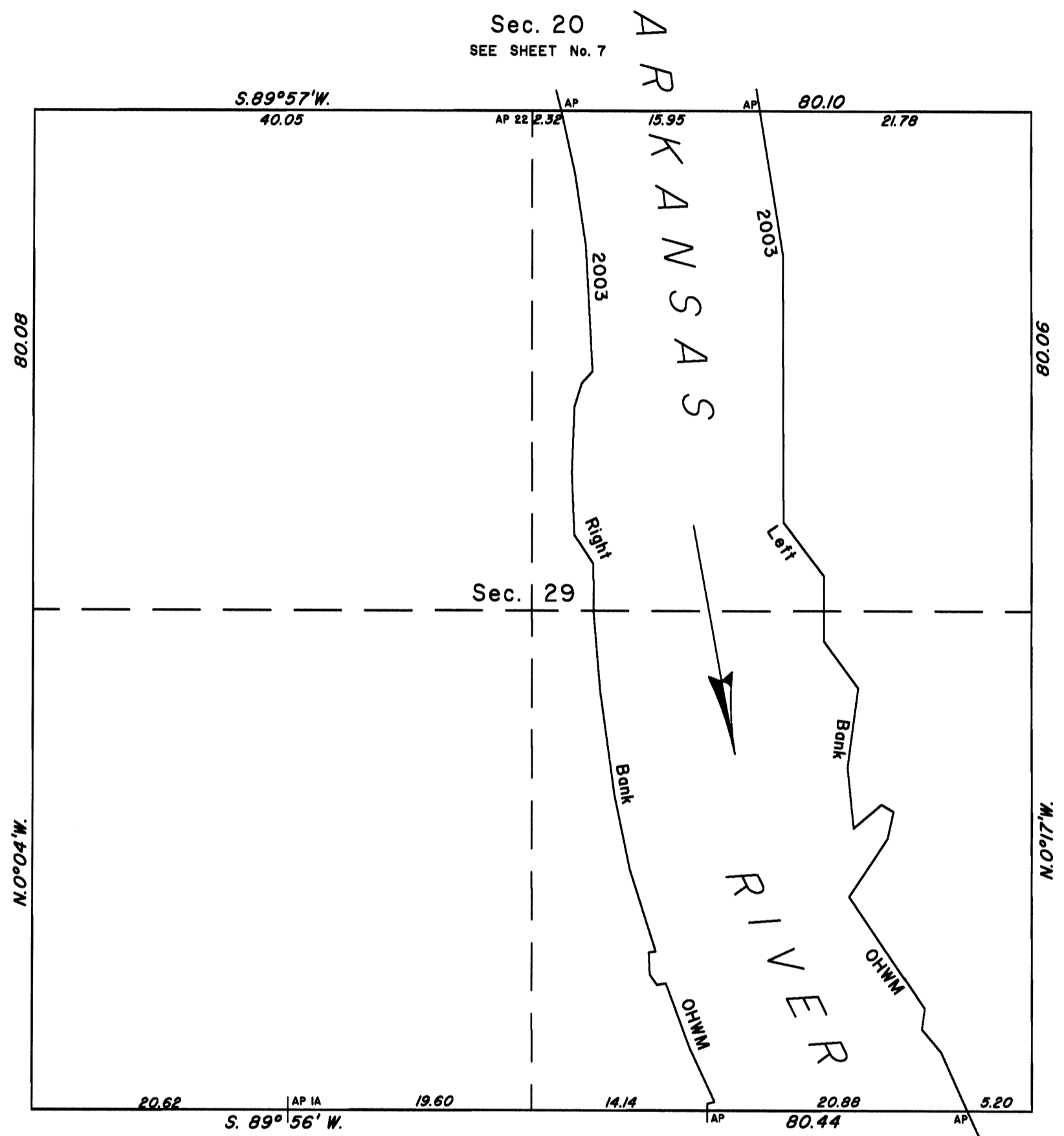

2003 Arkansas River in Section 29 Left Bank OHWM as Digitized	2003 Arkansas River in Section 29 Right Bank OHWM as Digitized
From AP, sections 29 and 32, at 2003 Left Bank OHWM, thence upstream in section 29:	From AP, sections 29 and 32, at 2003 Right Bank OHWM, thence upstream in section 29:
N.24°26'W., 5.16	N.1°07'W., 0.56
N.40°34'W., 2.39	N.76°18'E., 0.60
N.7°32'E., 1.67	N.25°06'W., 4.79
N.34°14'W., 10.85	N.20°20'W., 5.49
N.33°21'E., 5.60	S.80°45'W., 0.73
N.12°19'E., 2.19	N.34°52'W., 1.01
N.59°43'W., 1.12	N.2°41'W., 1.76
S.49°37'W., 2.93	N.80°34'E., 0.55
N.5°54'W., 4.90	N.17°43'W., 6.87
N.7°17'E., 6.41	N.11°55'W., 6.14
N.36°16'W., 4.63	N.8°01'W., 8.35
N.0°12'W., 2.45	N.5°03'W., 6.48
N.0°12'W., 2.79	N.0°13'W., 3.75
N.37°22'W., 5.39	N.33°50'W., 2.79
N.0°21'W., 21.40	N.2°28'W., 5.02
N.9°20'W., 11.72	N.2°11'E., 5.26
AP, sections 20 and 29	N.16°48'E., 1.94
	N.42°00'E., 1.31
	N.3°22'W., 10.07
	N.8°46'W., 5.91
	N.12°33'W., 5.11
	AP, sections 20 and 29

Sec. 32
SEE SHEET No. 14

2003
Arkansas Riverbed
in Section 29
Claim Area ±143.42 Acres

Reference should be made to sheet No. 1 for survey and disclaimer information.

UNITED STATES DEPARTMENT OF THE INTERIOR
BUREAU OF LAND MANAGEMENT

Sante Fe, New Mexico April 30, 2010

This plat is strictly conformable to the approved field notes, and the survey, having been correctly executed in accordance with the requirements of law and the regulations of this Bureau, is hereby accepted.

For the Director

Chief Cadastral Surveyor for New Mexico

