

TOWNSHIP 10 NORTH, RANGE 26 EAST, OF THE INDIAN MERIDIAN, OKLAHOMA  
SUPPLEMENTAL PLAT

2003 Arkansas Riverbed in Section 28

From AP, sections 27 and 28, at 2003 Left Bank OHWM, thence upstream in section 28;	S.22°48'E., 0.21
	S.55°35'E., 0.62
N.37°30'W., 0.41	S.69°04'E., 0.35
N.37°30'W., 8.23	N.89°12'E., 0.61
S.10°09'W., 2.87	S.4°10'E., 1.81
N.29°15'W., 4.07	N.55°22'E., 1.03
N. 8°37'E., 2.62	S.34°42'E., 11.07
N.24°48'W., 4.23	S.65°19'E., 0.35
N.51°16'W., 5.18	S.37°27'E., 2.25
S.40°50'W., 9.06	S.34°21'E., 0.41
N.41°37'W., 3.16	S.28°46'E., 0.90
N.26°13'W., 18.51	S.20°08'E., 0.39
N.26°13'W., 8.61	S.13°02'E., 0.78
N.36°06'W., 9.07	S.16°28'E., 0.64
N.27°16'E., 1.93	S.17°08'E., 2.30
N.60°45'E., 1.81	S.35°01'E., 2.05
N.51°07'E., 1.44	S.35°01'E., 3.37
N.49°12'E., 1.72	S.44°44'E., 4.09
N.38°12'E., 1.09	S.44°44'E., 4.15
AP, sections 21 and 28,	S.48°22'E., 4.49
S.89°31'W., 6.98	S.53°04'E., 0.74
1897 MC, sections 21 and 28,	S.44°12'E., 4.69
N.69°39'W., 28.63	S.53°15'E., 7.10
AP, sections 21 and 28 at 2003 Right Bank OHWM, thence downstream;	S.51°37'E., 6.11
S.44°05'E., 11.60	S.57°07'E., 4.40
S.35°41'E., 5.92	S.60°17'E., 13.07
S.42°07'E., 1.43	S.68°55'E., 0.24
S.53°48'E., 0.89	AP, sections 27 and 28,
S.13°17'W., 0.28	N. 0°37'E., 16.61
continued on next column	AP, sections 27 and 28, at 2003 Left Bank OHWM, place of beginning, containing
	± 139.67 Acres Claim Area

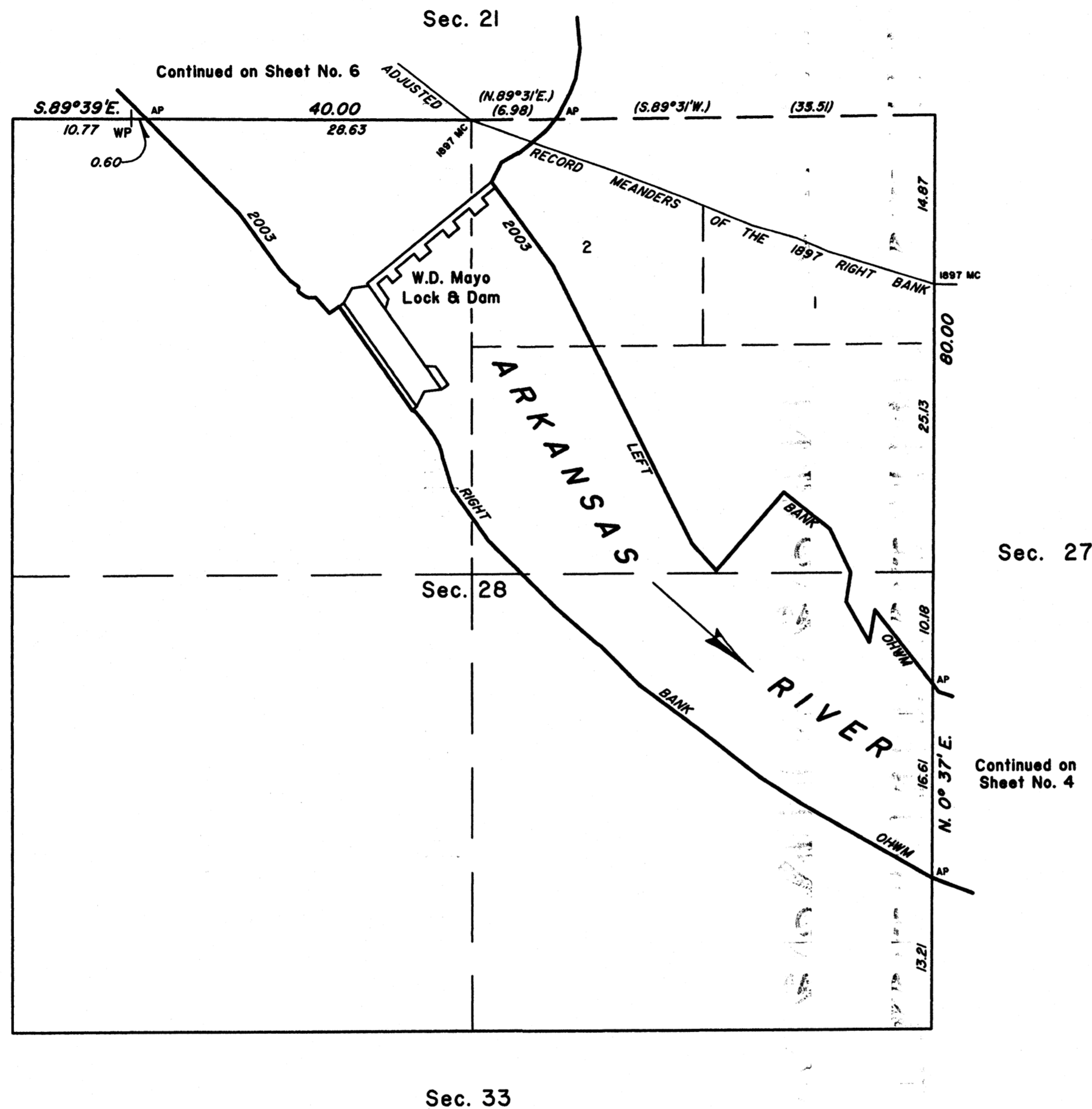

Reference should be made to sheet No. 1 for survey information.

UNITED STATES DEPARTMENT OF THE INTERIOR  
BUREAU OF LAND MANAGEMENT

Santa Fe, New Mexico October 2, 2008

This plat, showing amended boundaries and areas is based upon the official records and, having been correctly prepared in accordance with the regulations of this Bureau is hereby accepted.

For the Director

*John A. Casian*

Chief Cadastral Surveyor for New Mexico